



# MAD SCIENTIST LAB

LOCATION - ONE OF THE TOWERS

INSIDE - HEXAGON SHAPED

RATHER THAN CIRCULAR - FOR PERSPECTIVE

- WALLS MADE OF RECTANGULAR CUT STONES OF VARIOUS SIZES.

- FLOORS ARE MADE OF LARGE WOOD PLANKS

- STAIRS ARE SPIRAL BUT NOT CONNECTED TO WALLS AND GIRLE AROUND LARGE METALIC MACHINE IN THE CENTER OF THE TOWER

Room is oblong 30' x 20'



- CEILING IS 60' HIGH WITH PEAKED ROOF BEAMS COVERED IN WOOD TILES WITH AN OPENING ALONG THE LONG SIDE WITH HINGED DOORS THAT OPEN OUT

MAYBE TONE DOWN THE SCALE  
A BIT SEE NEXT SKETCH OF  
MACHINE





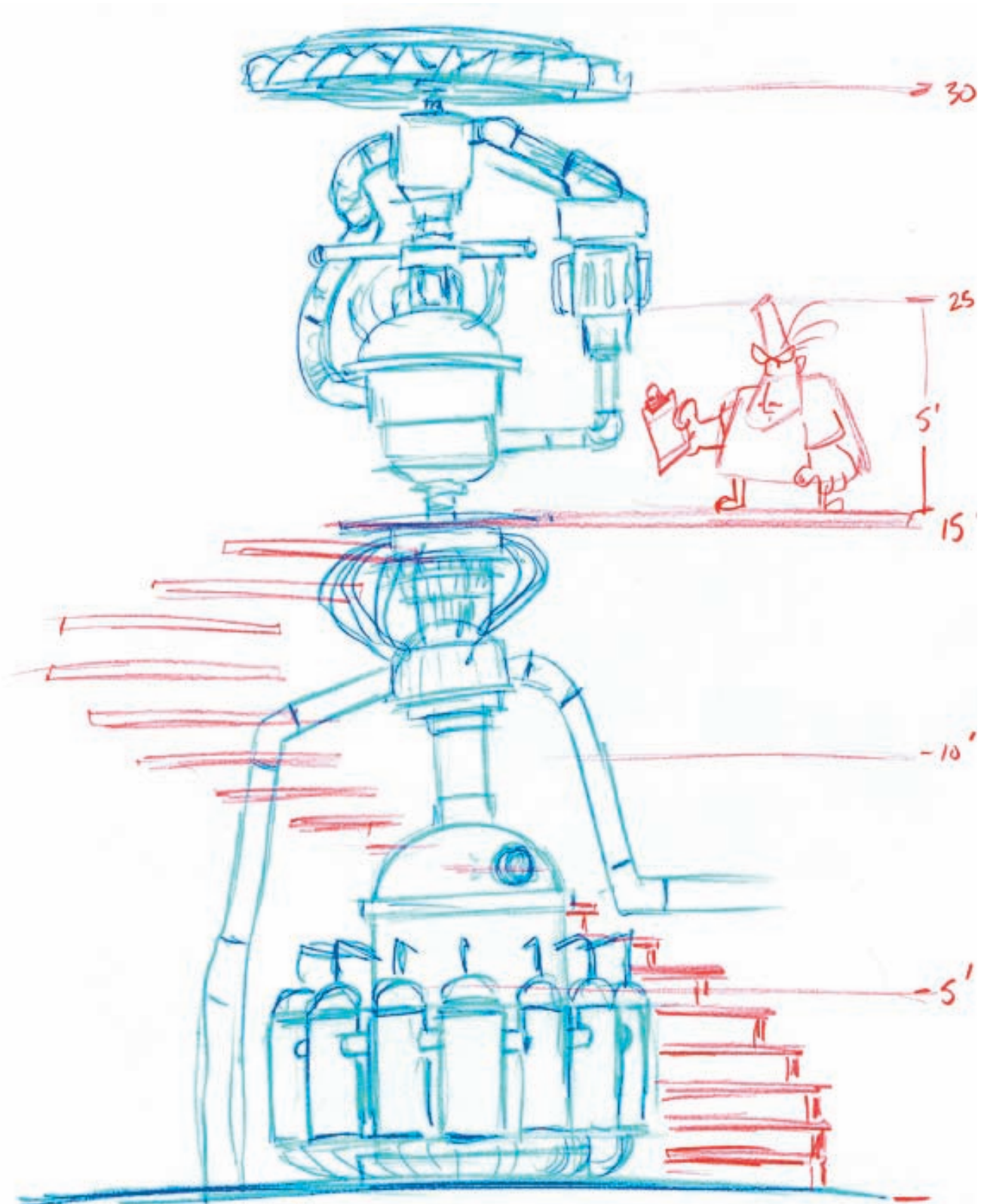



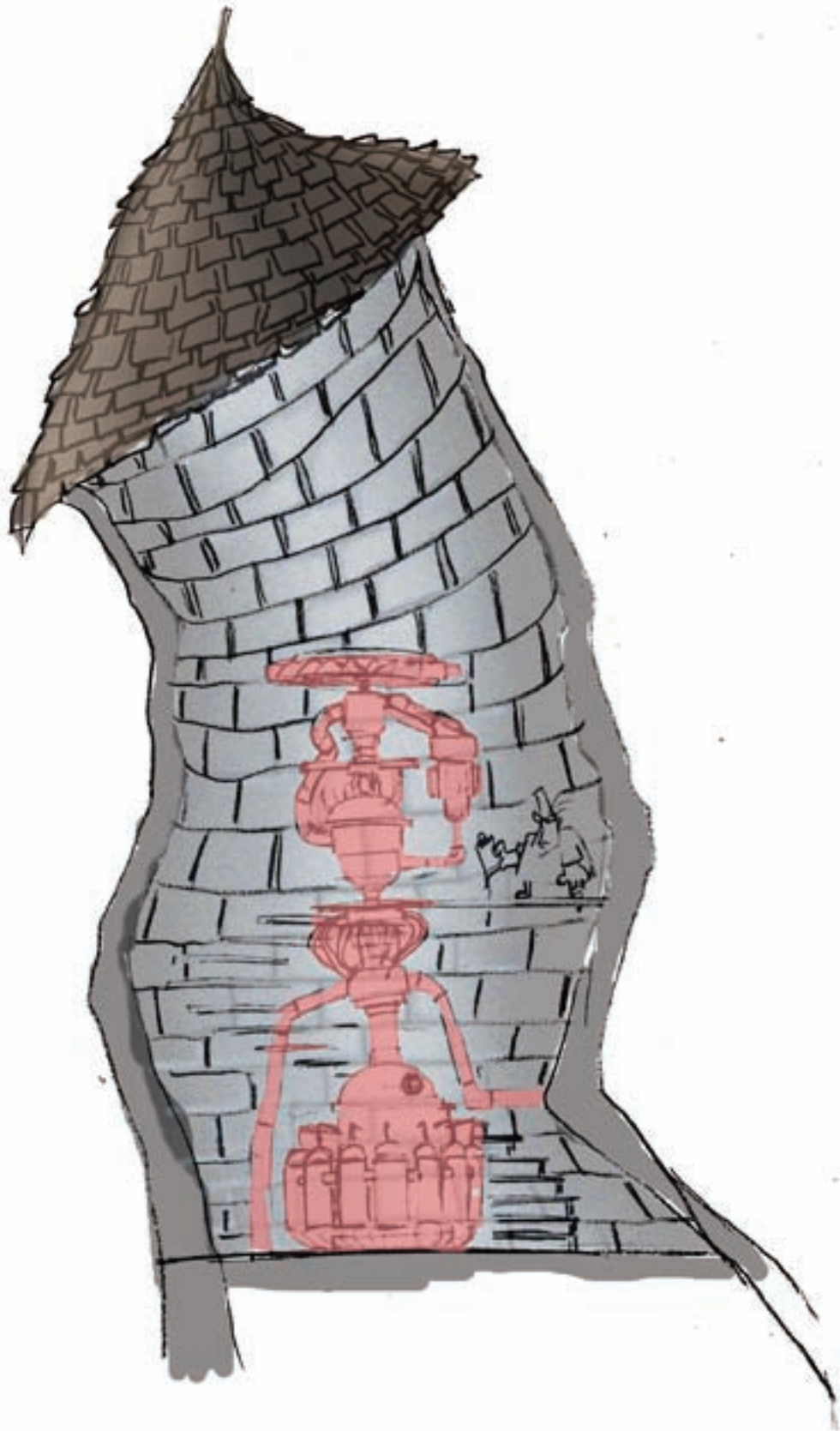





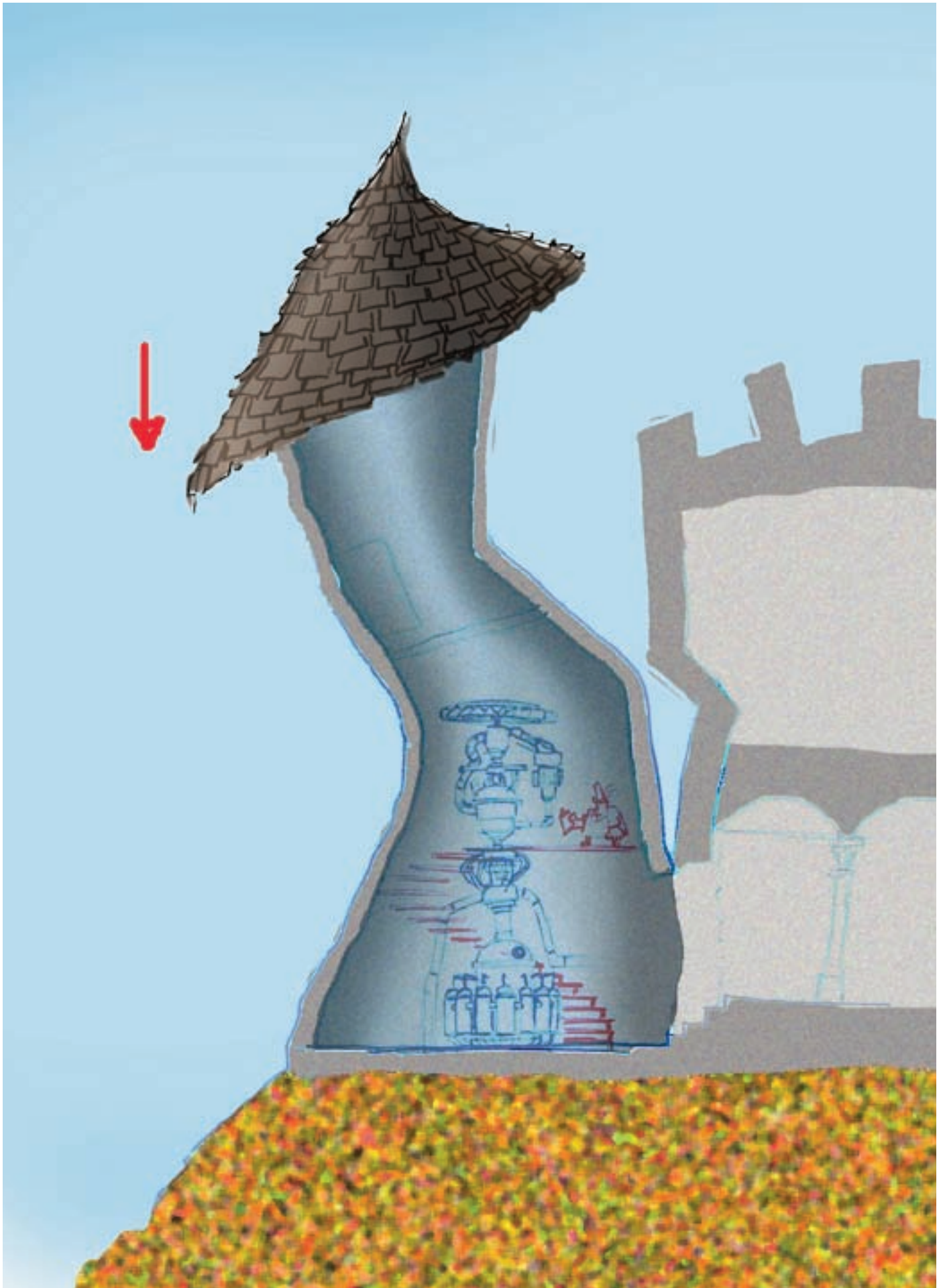

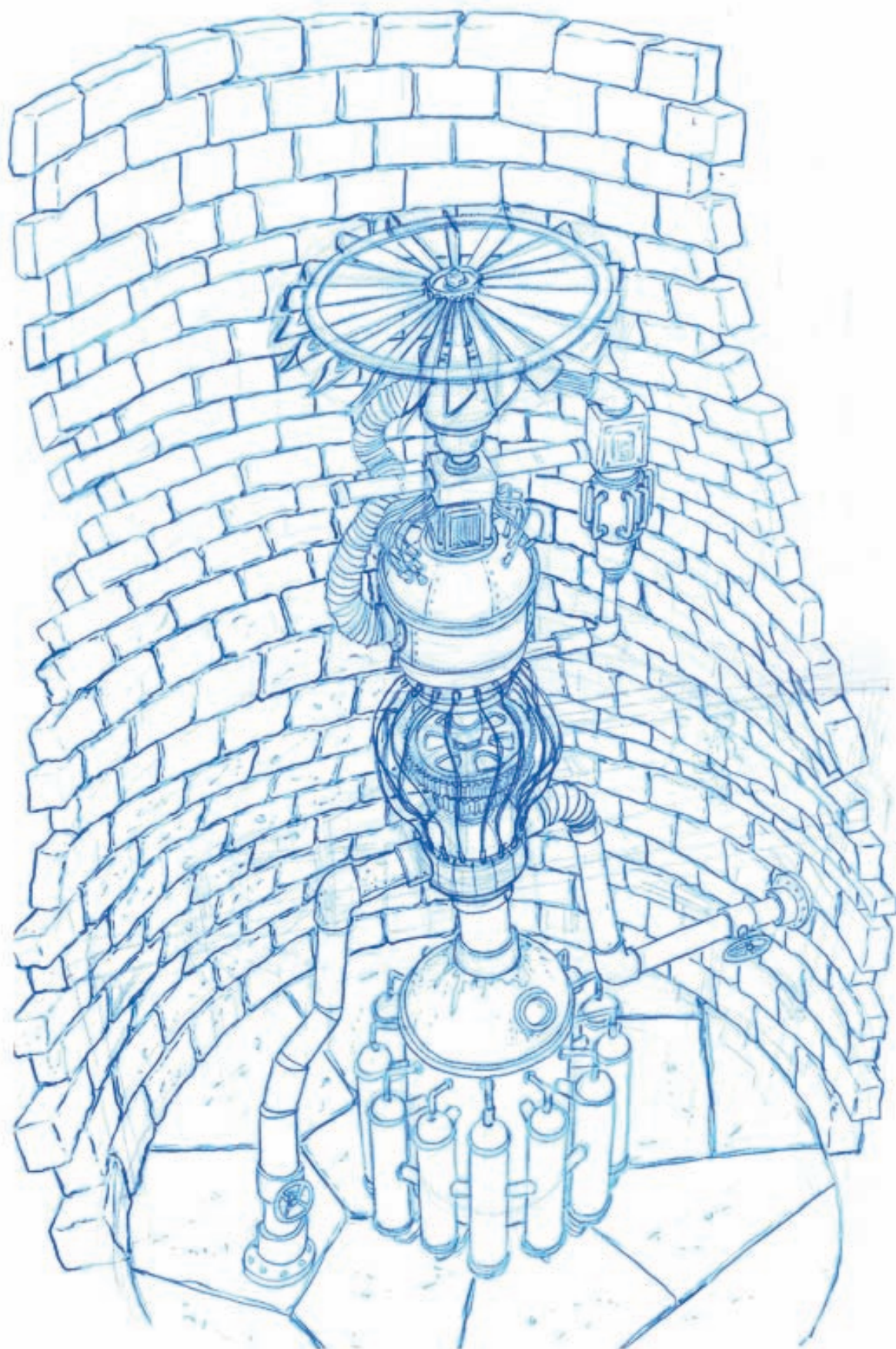



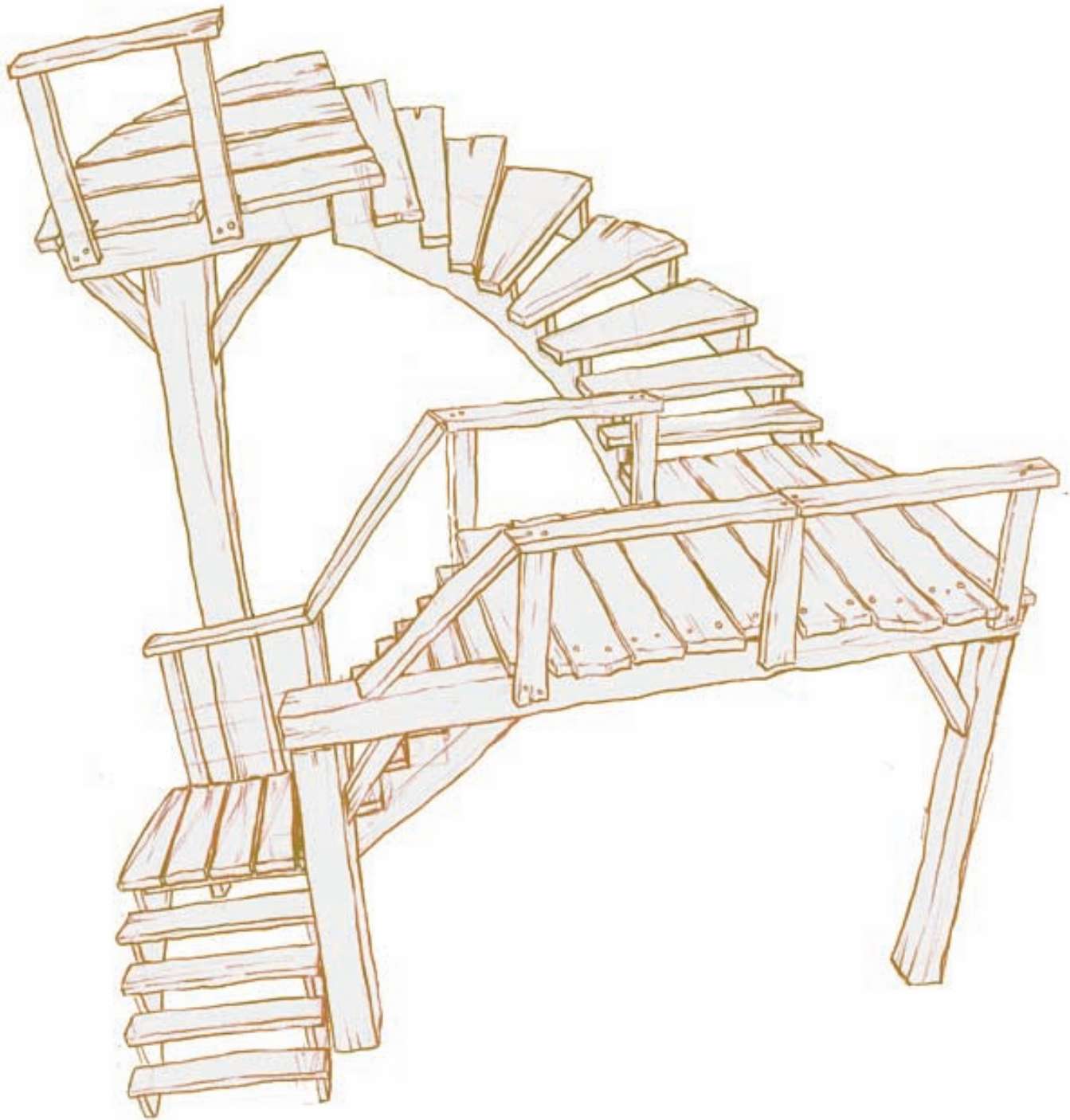



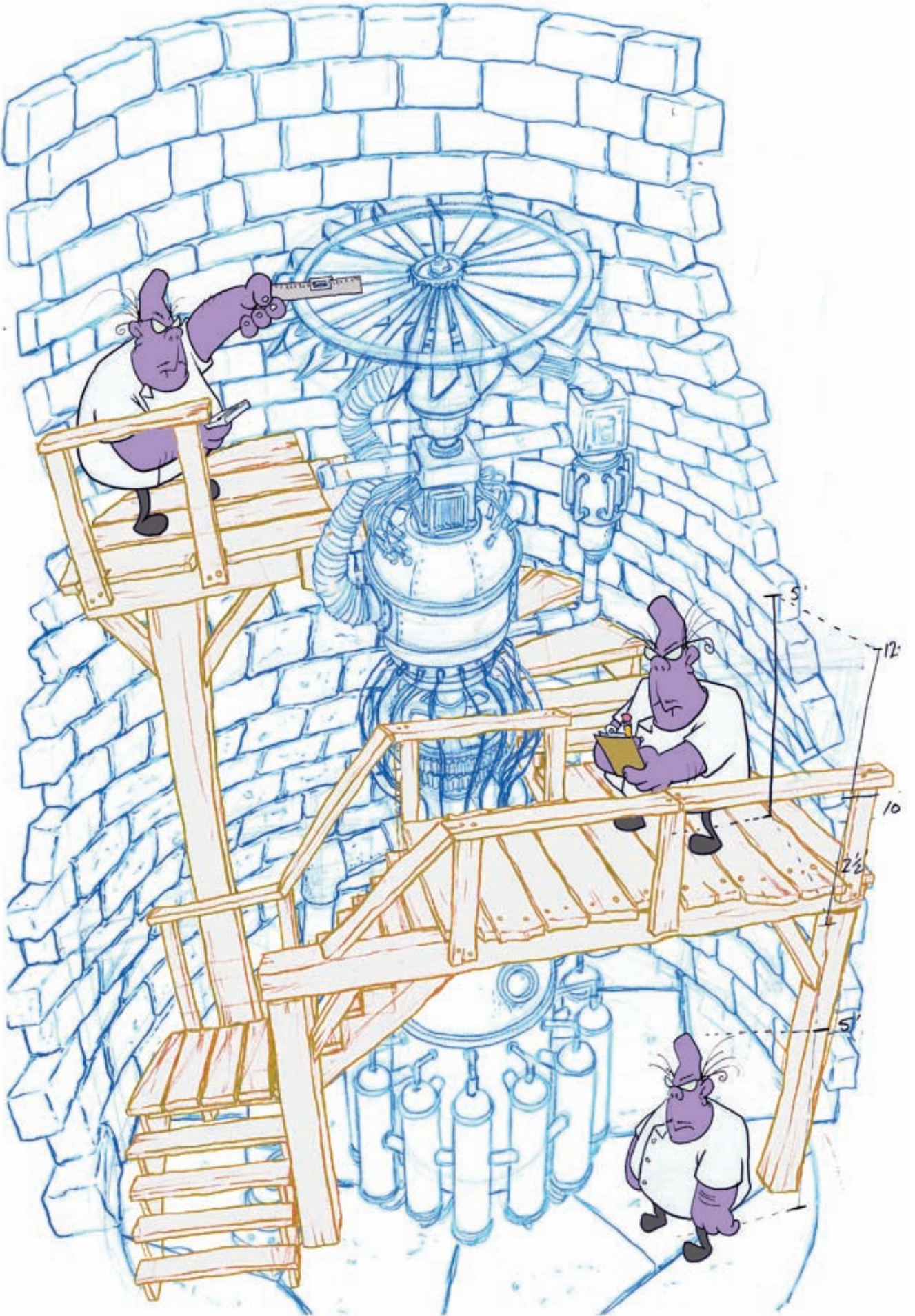



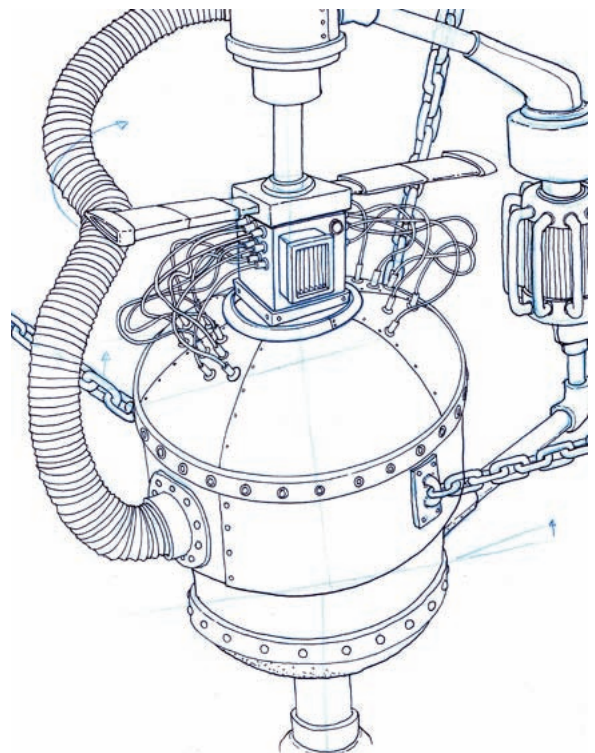
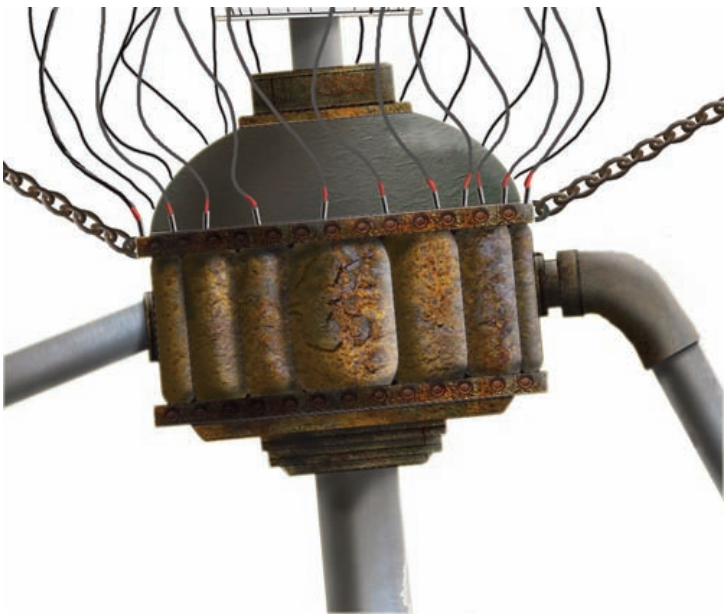



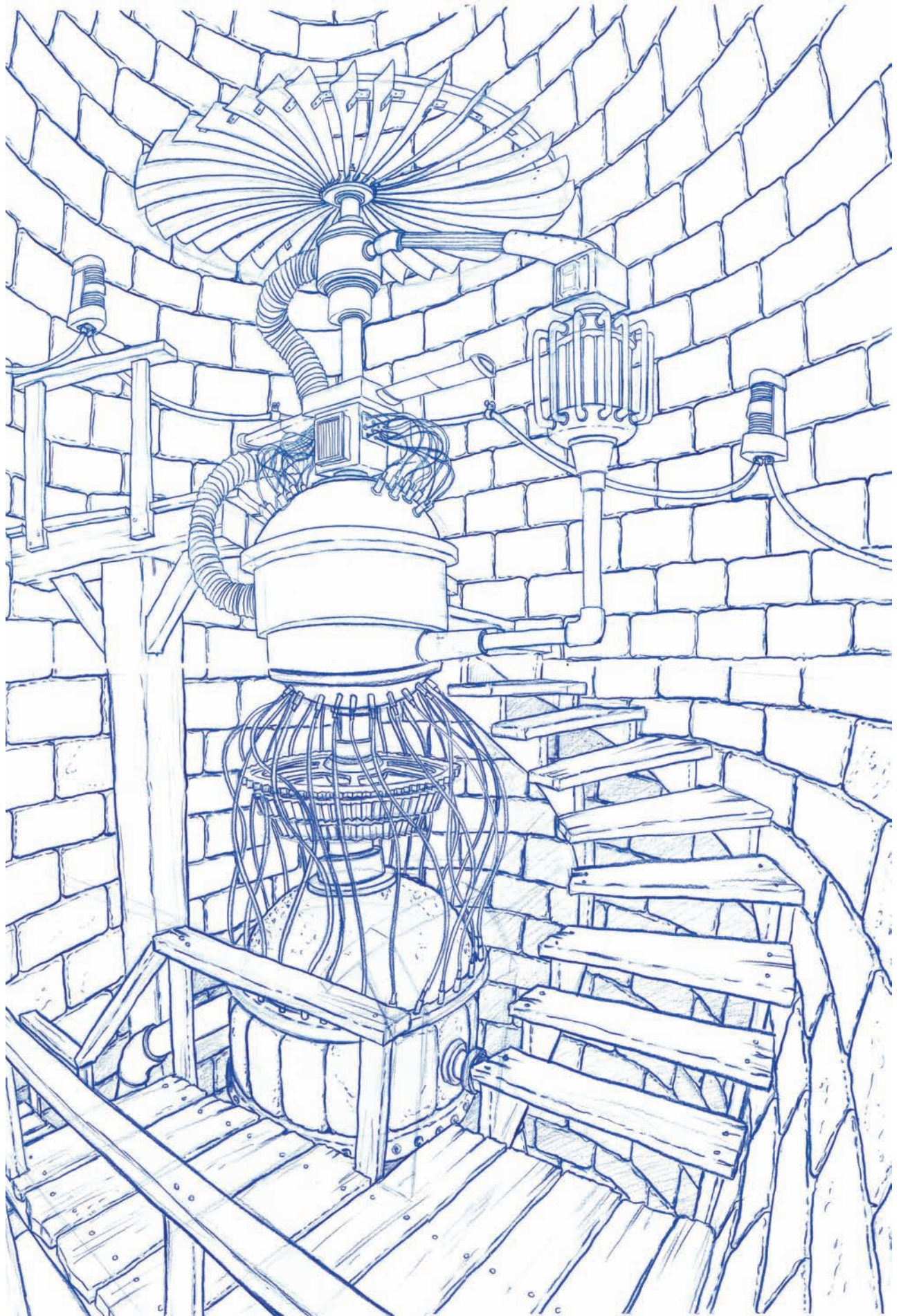



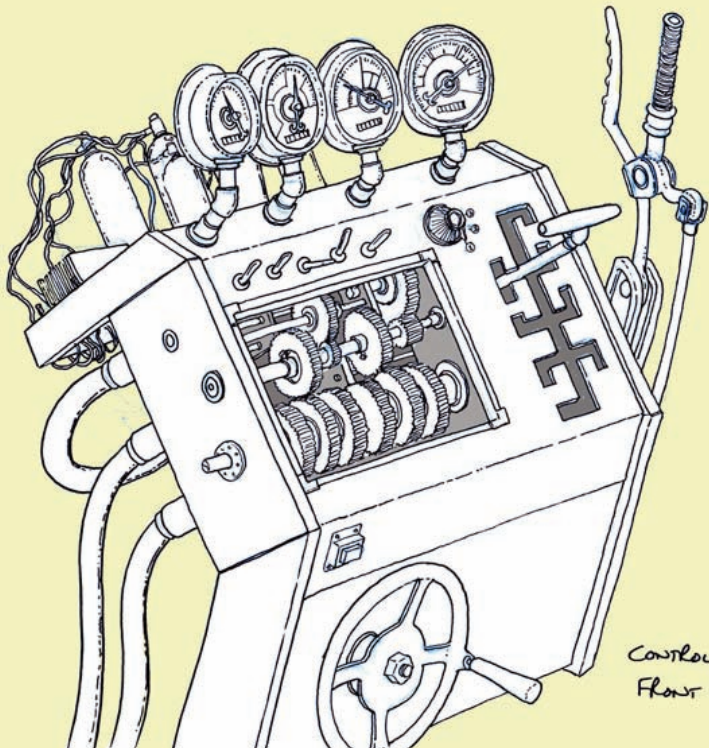

CONTROL PANEL  
FRONT VIEW

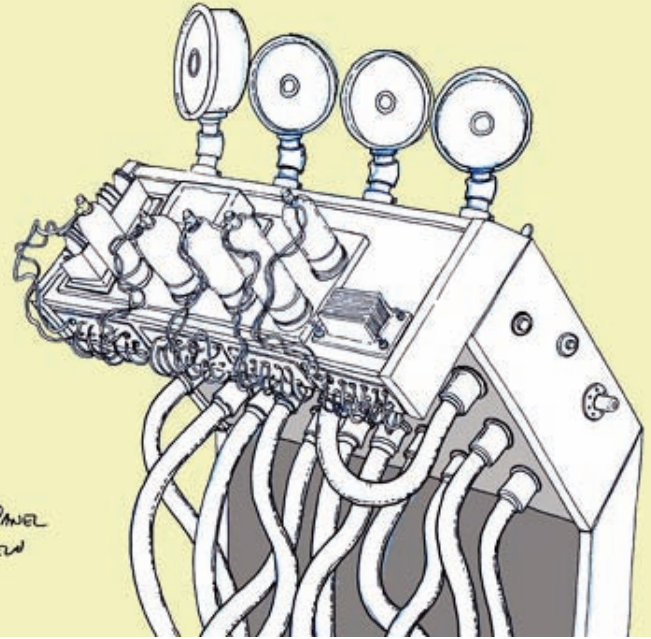

CONTROL PANEL  
REAR VIEW

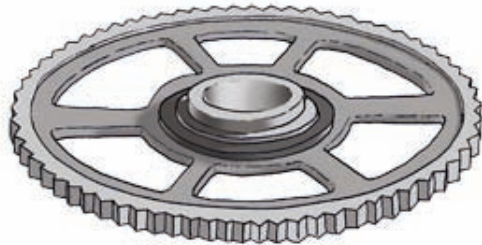

3 GEARS

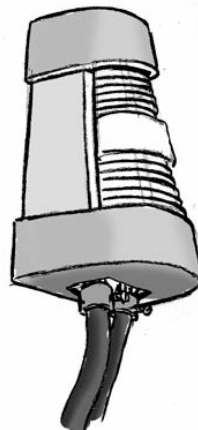
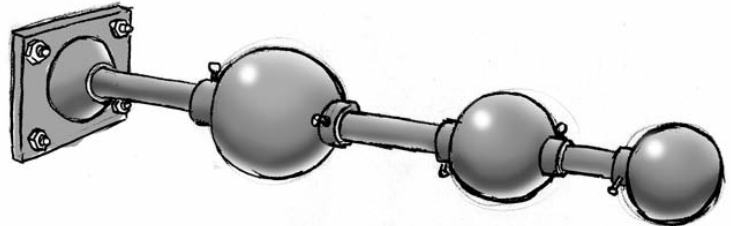
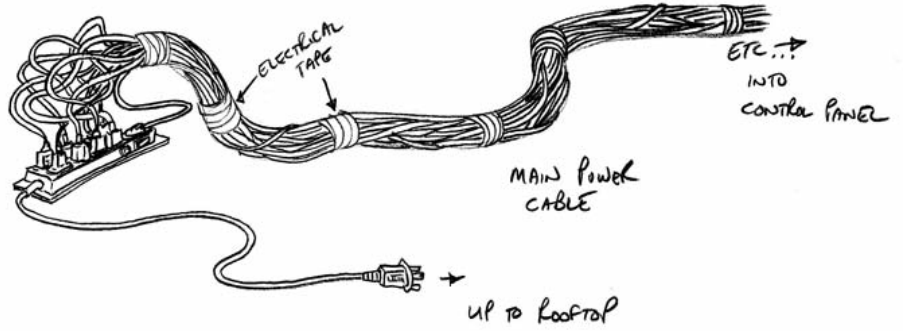
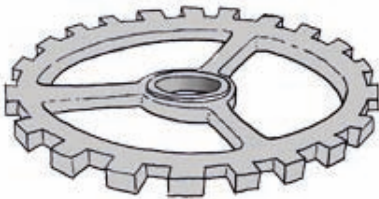
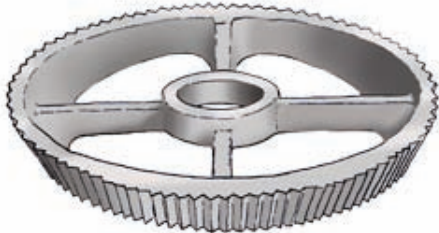



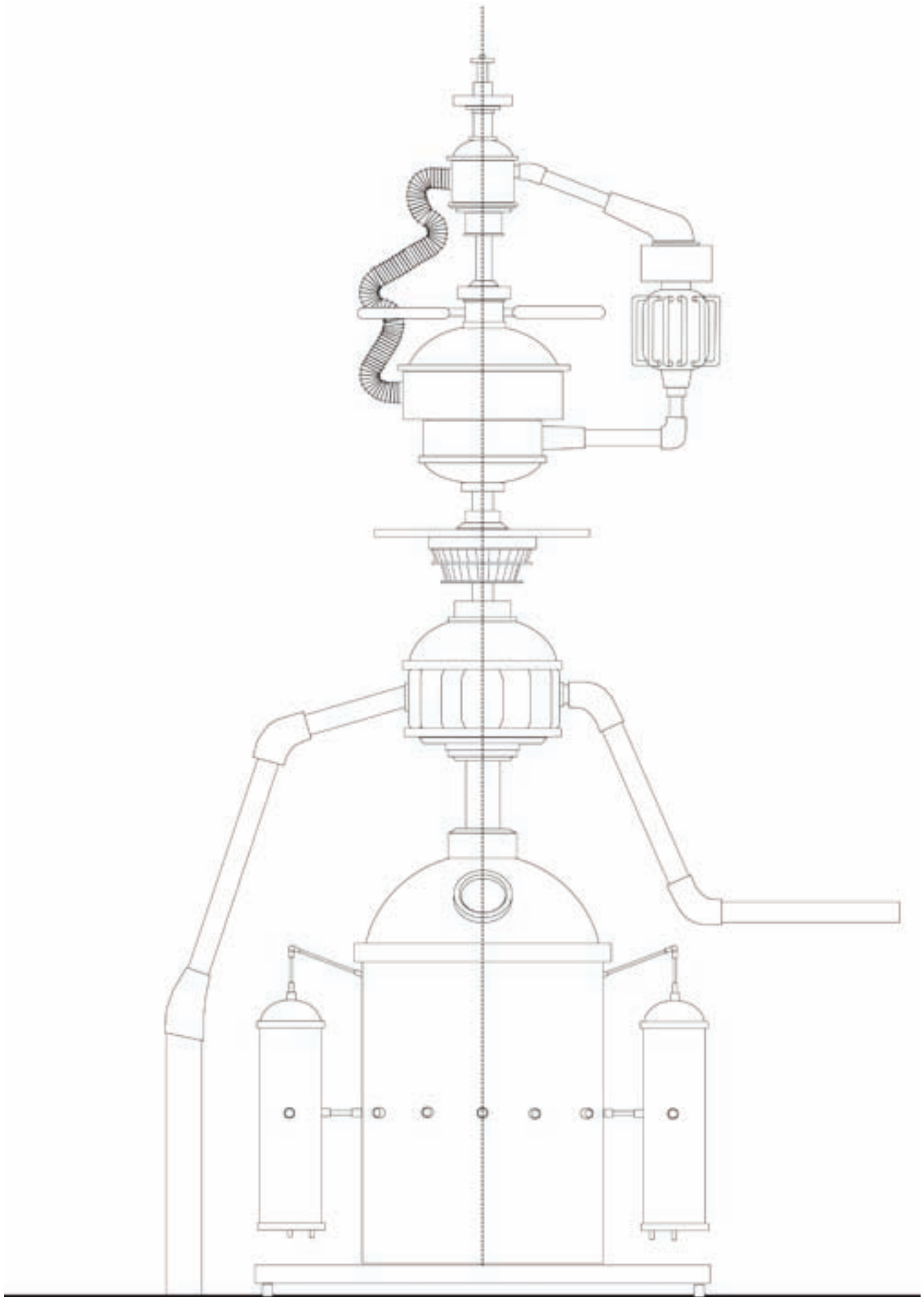



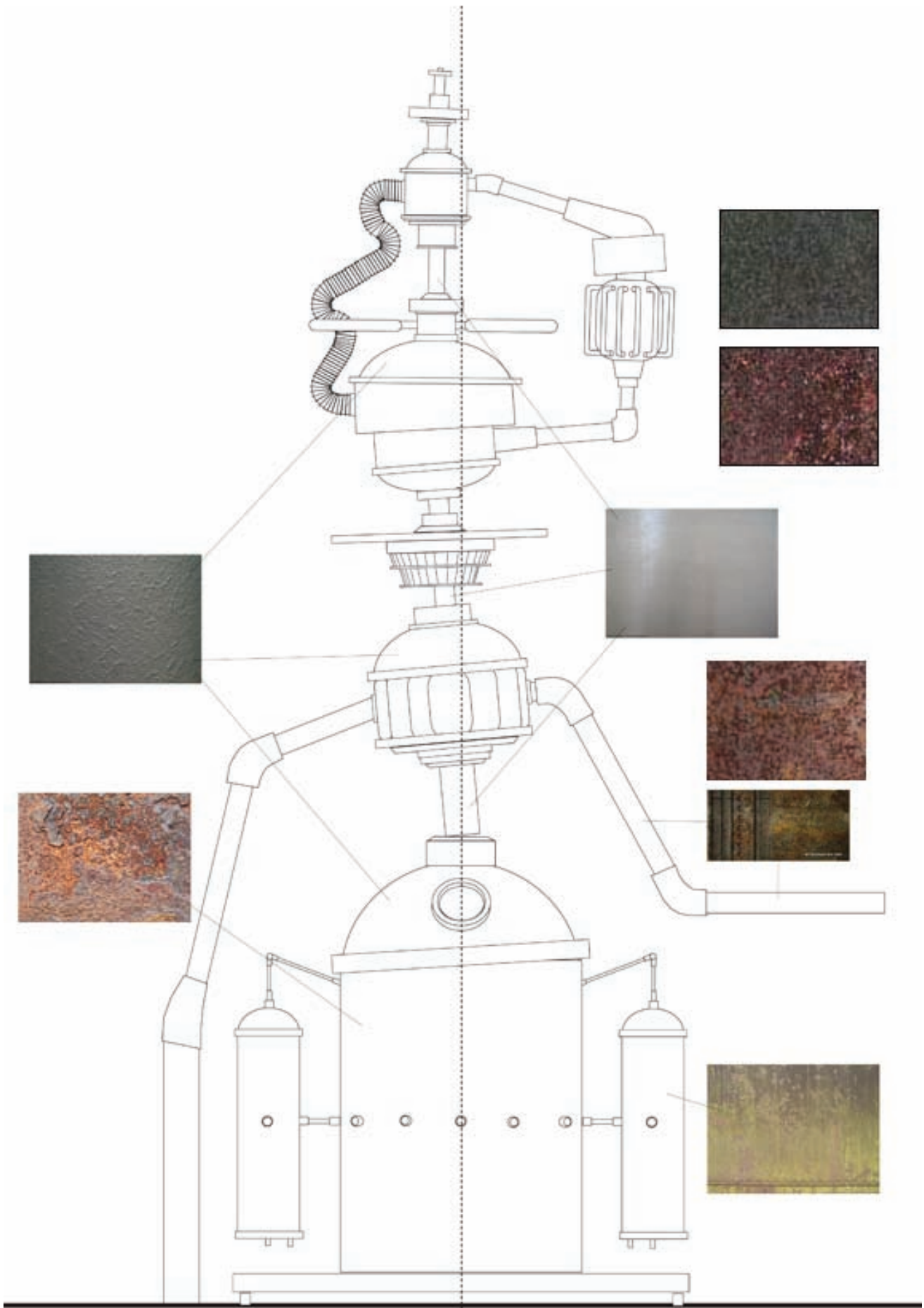

**Floor stone  
Pattern**

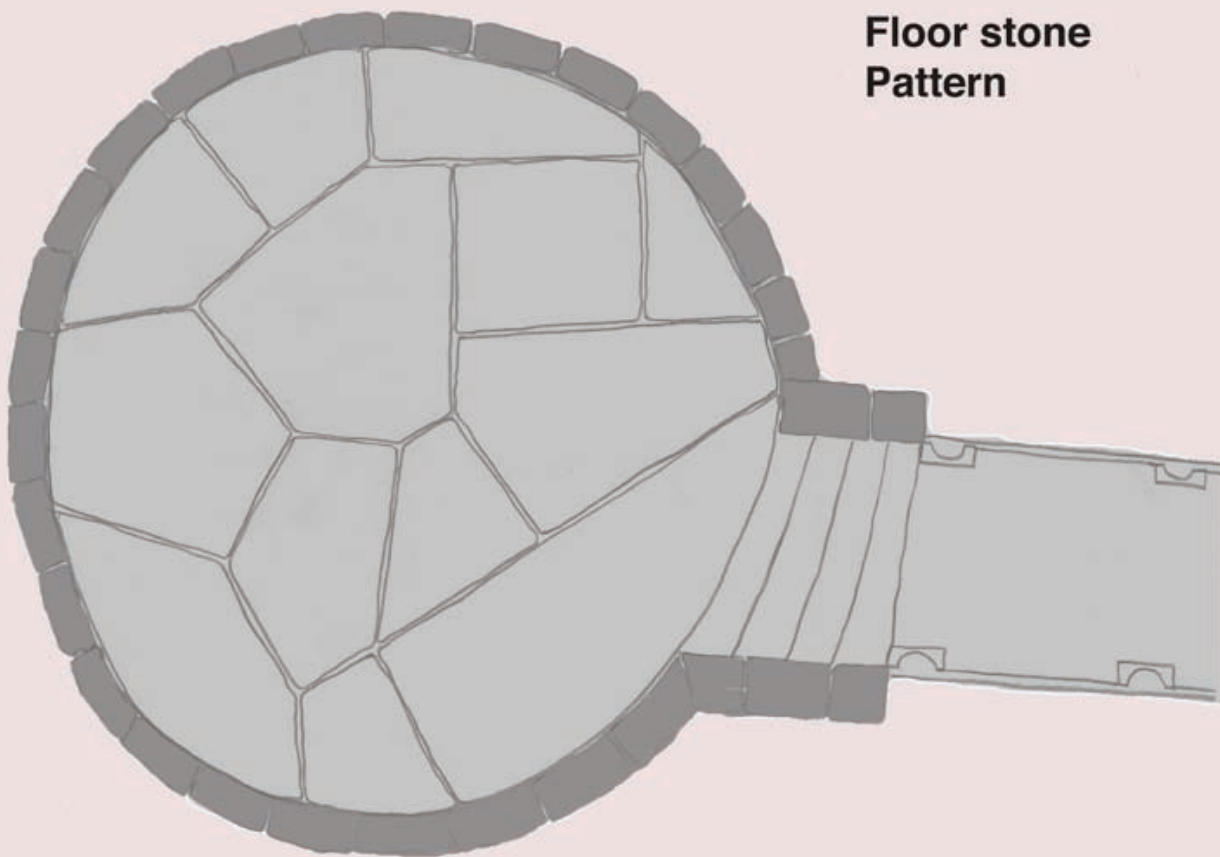

**Machine Base**

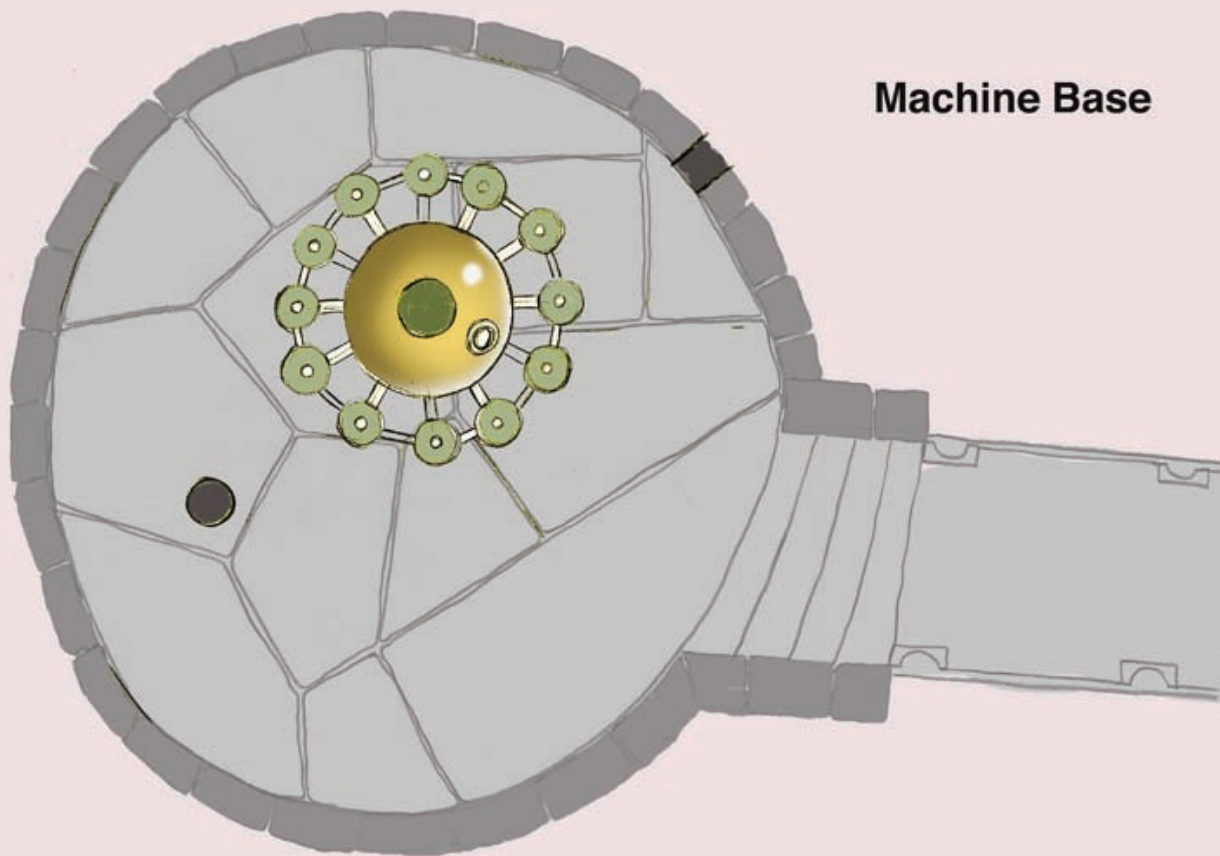



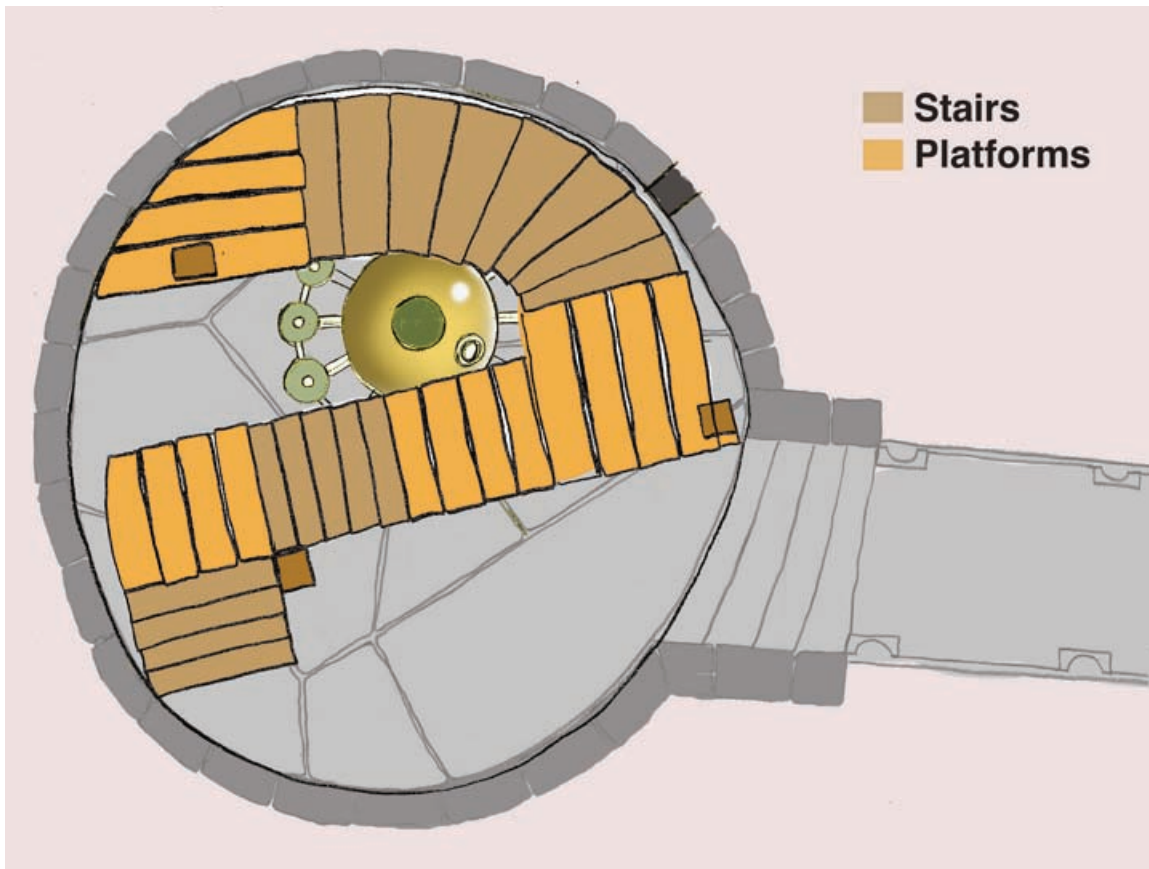
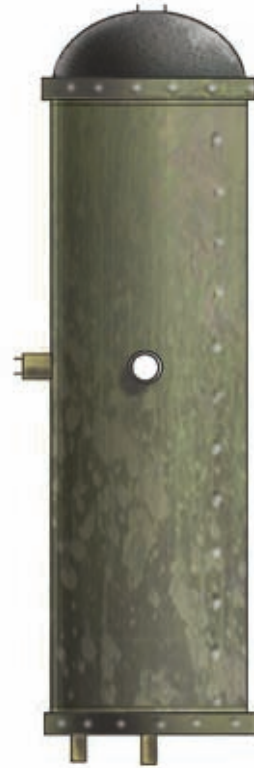

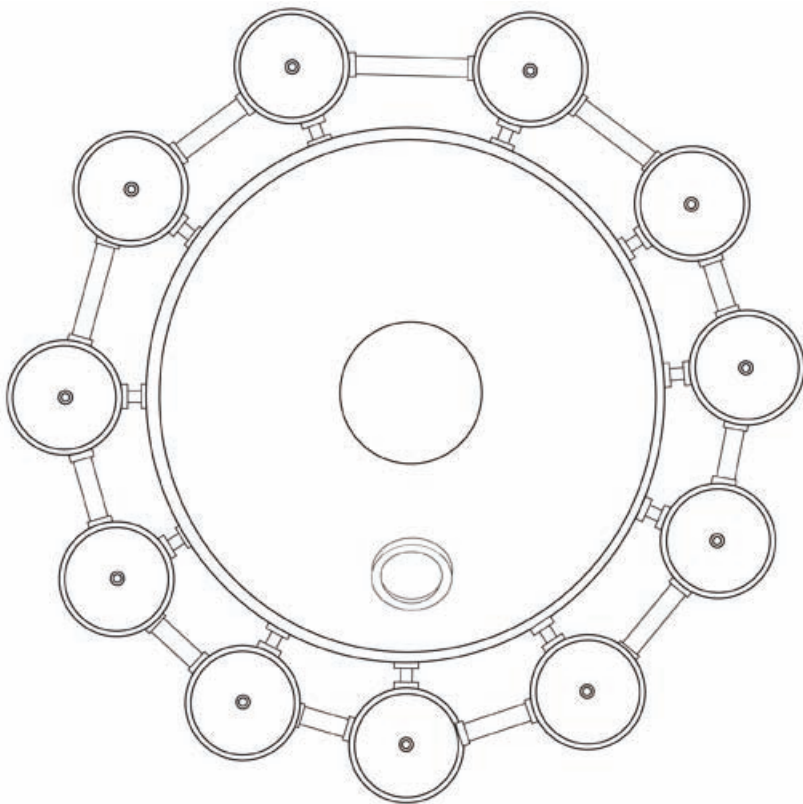
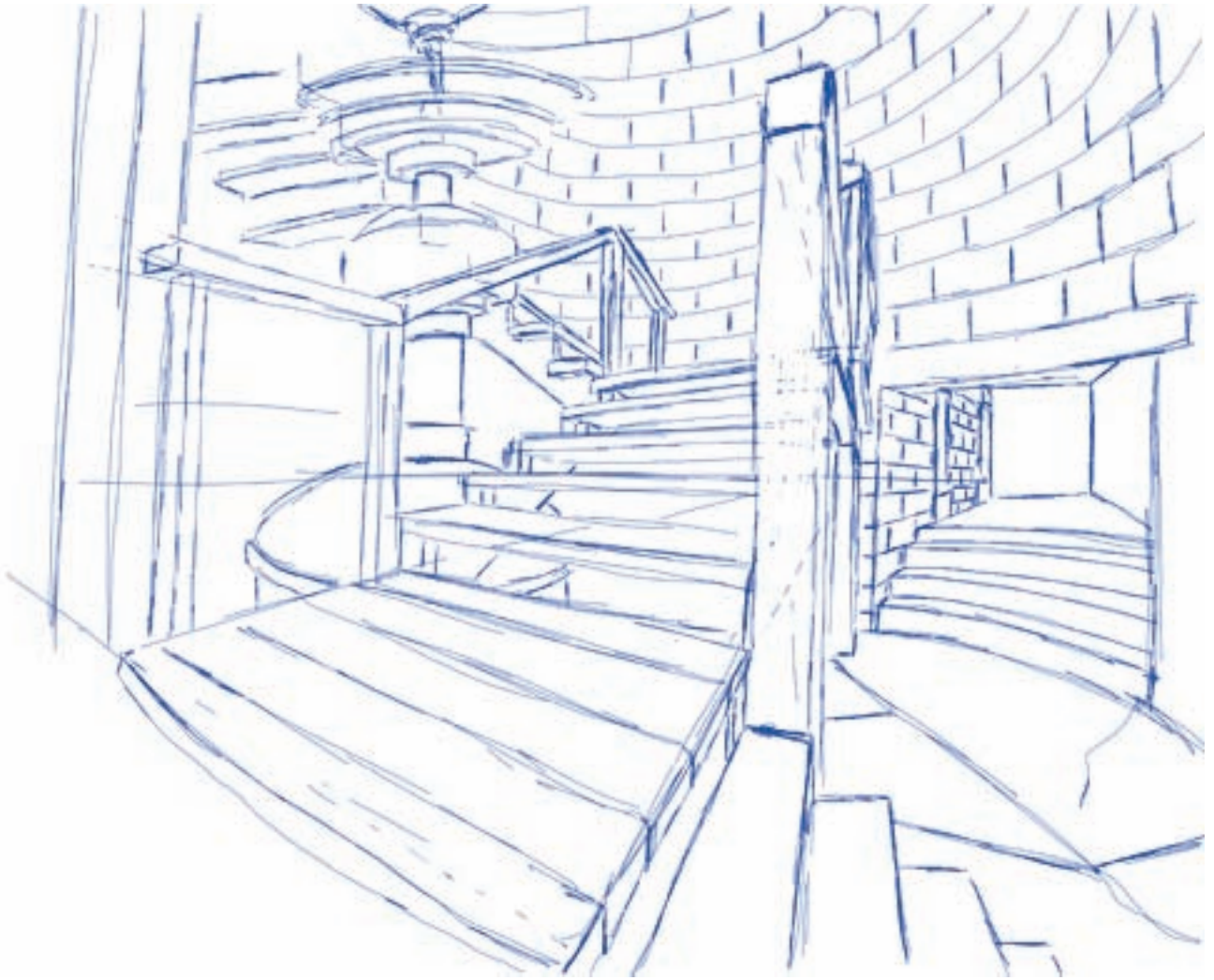



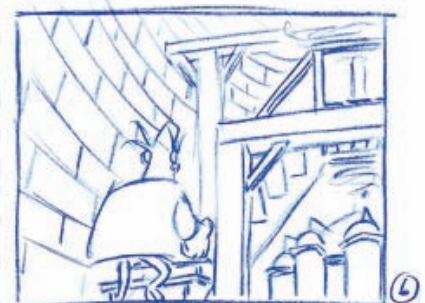
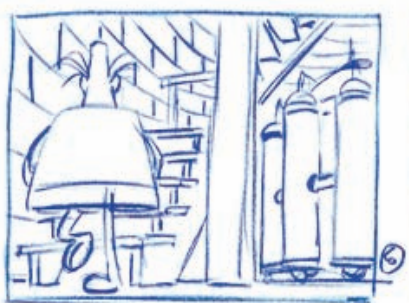
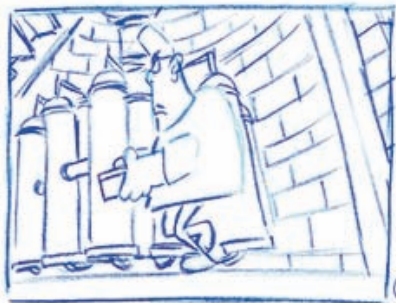
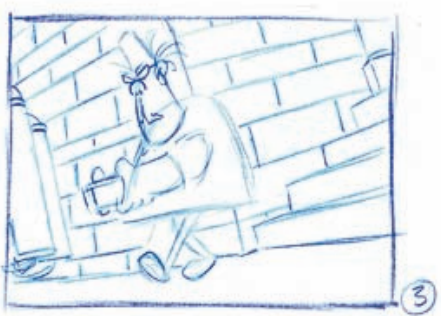
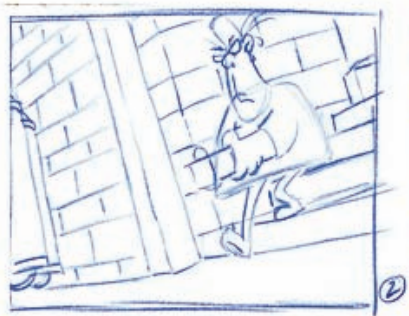
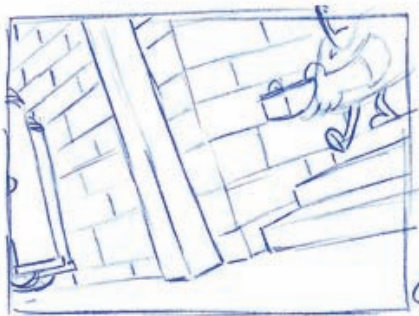
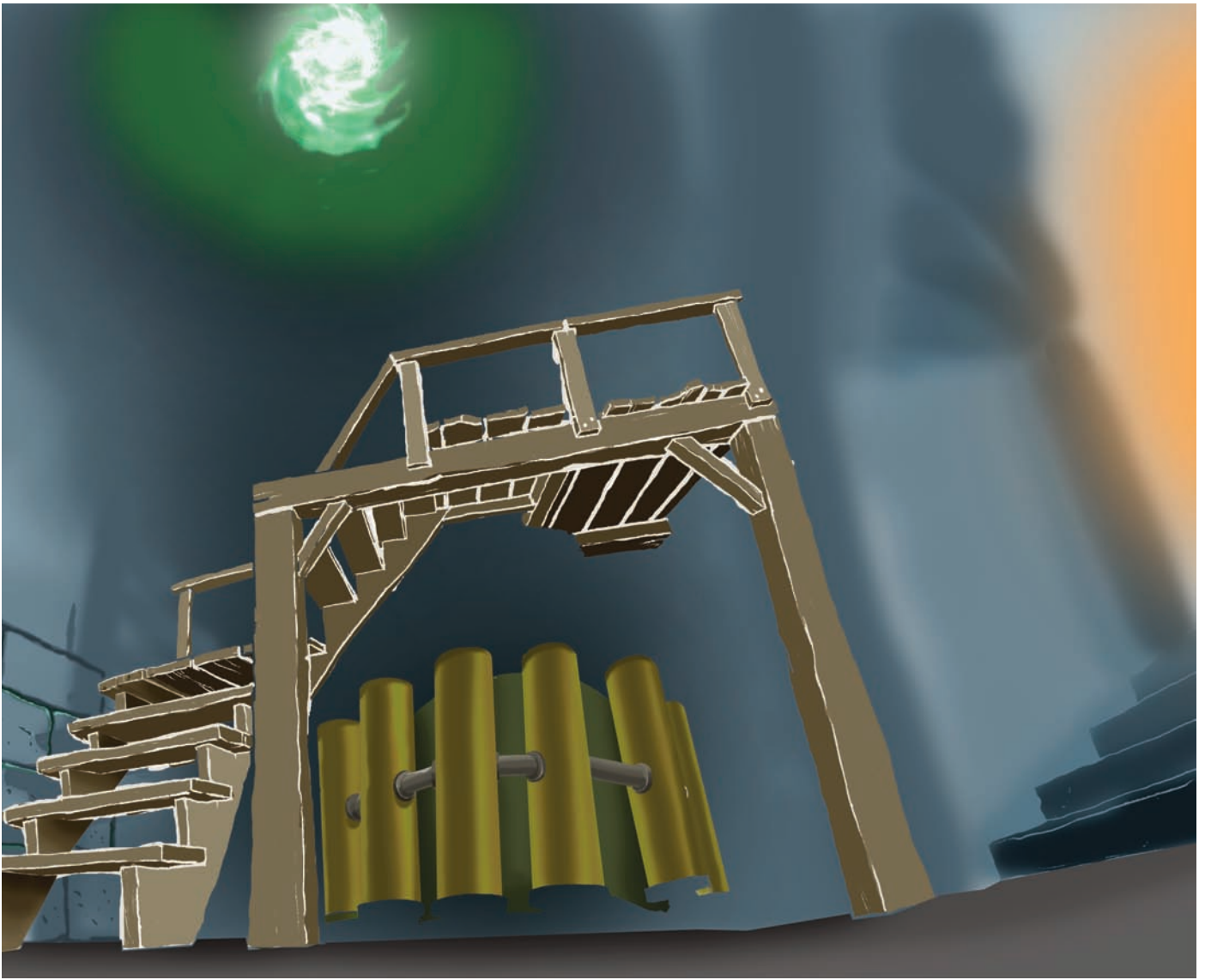



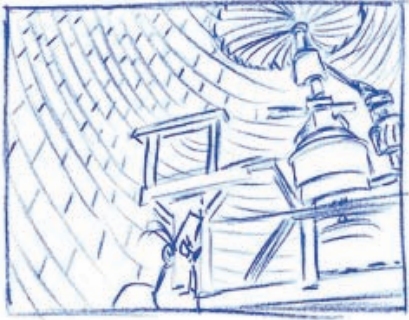

7

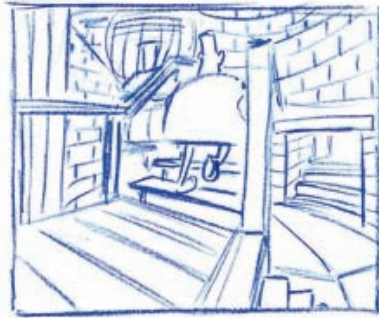

8

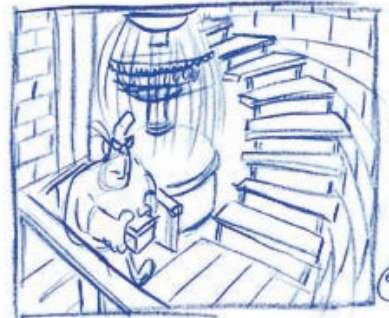

9

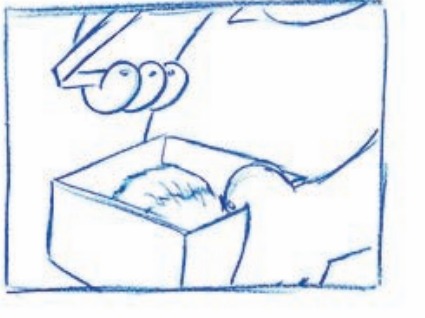
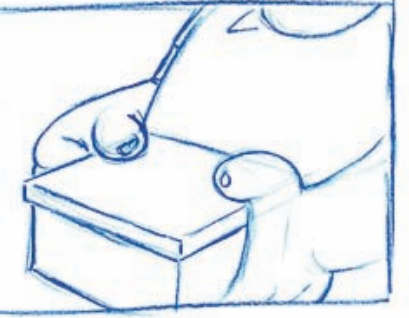
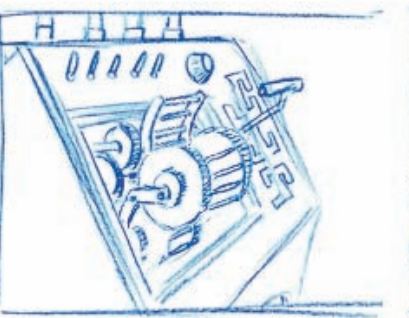
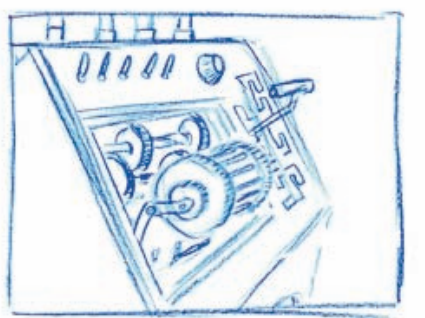
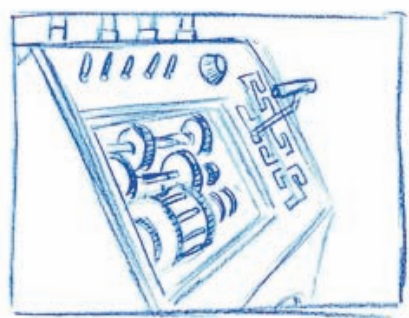
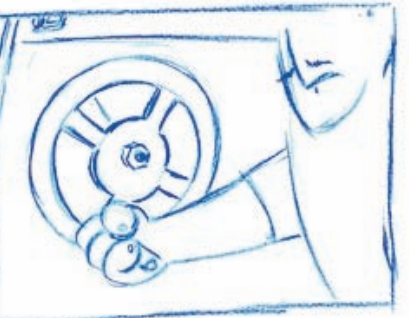
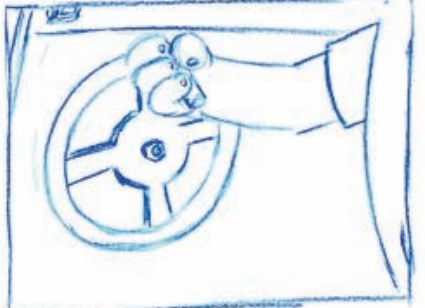
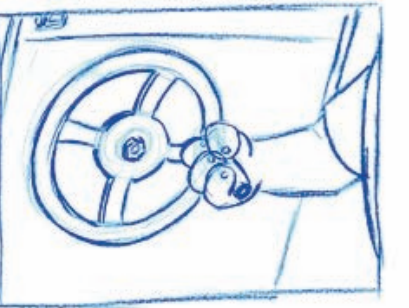
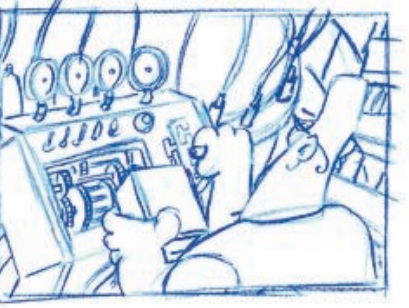
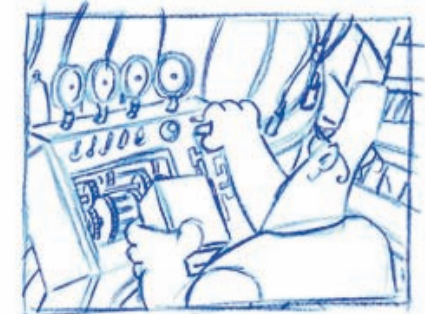
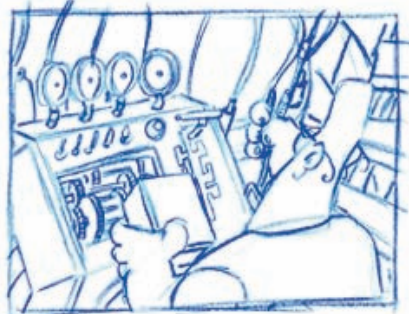
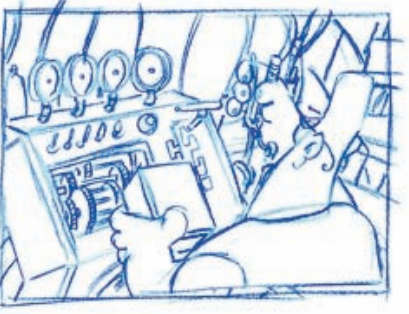



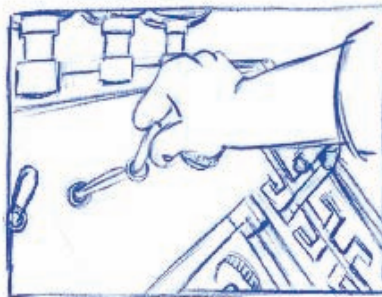
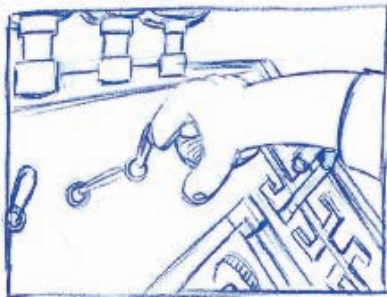
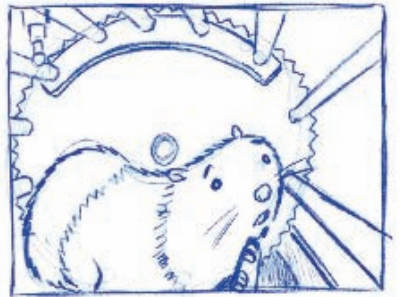
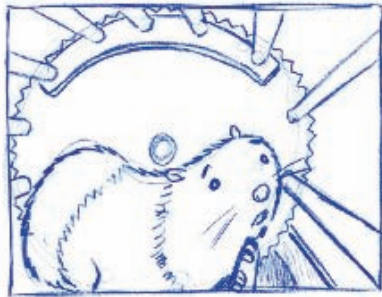
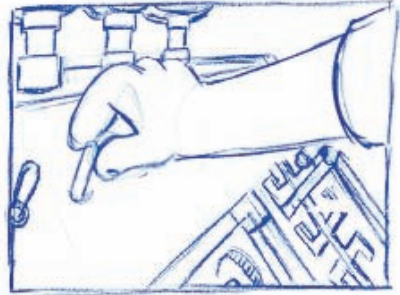
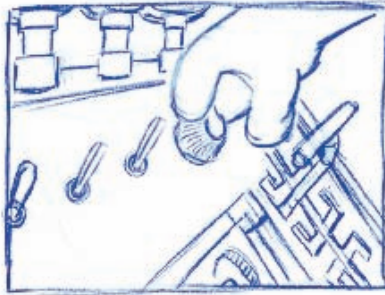
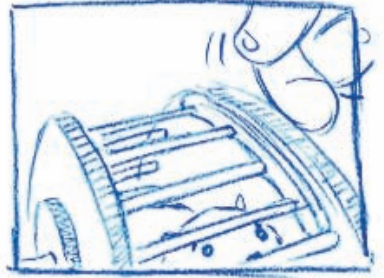
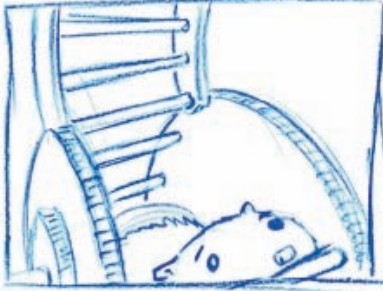
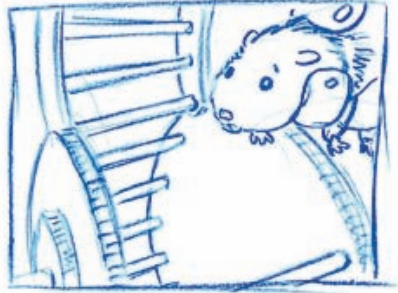



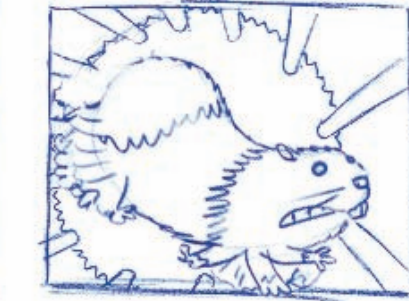
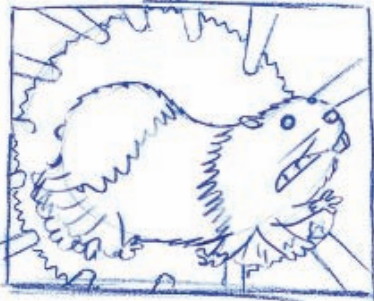
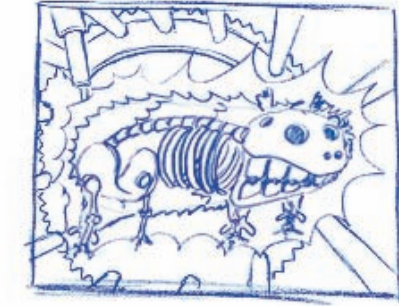
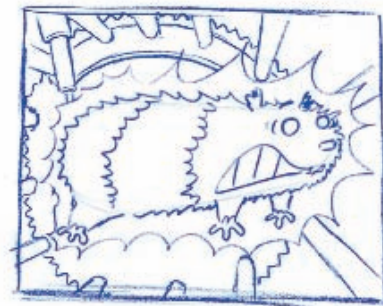
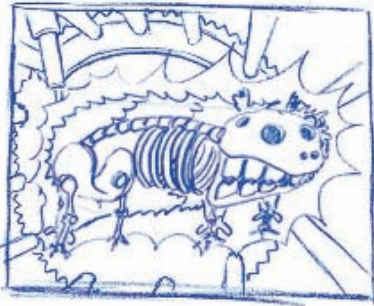
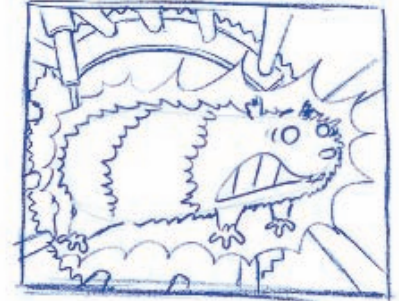
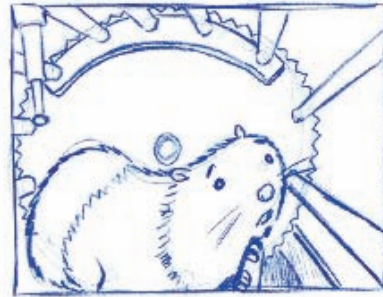
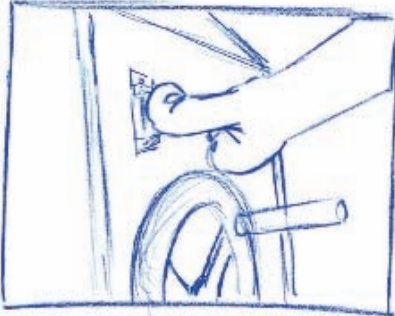
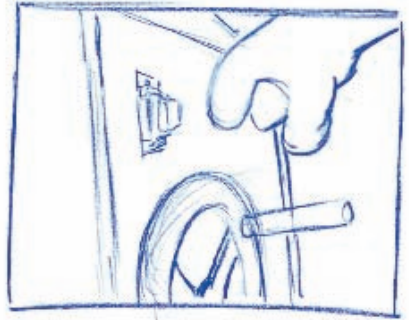
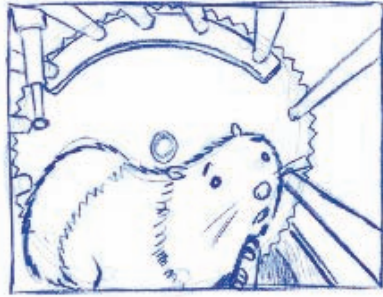
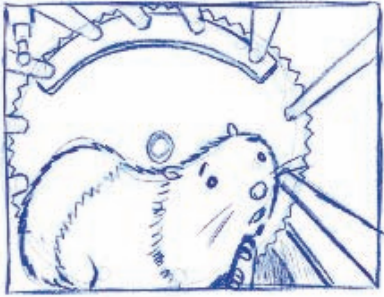



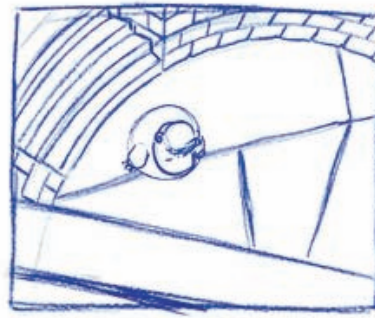
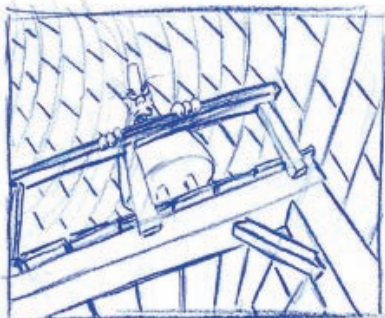
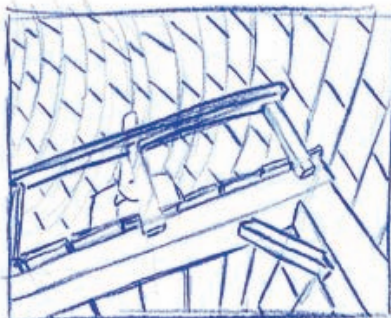
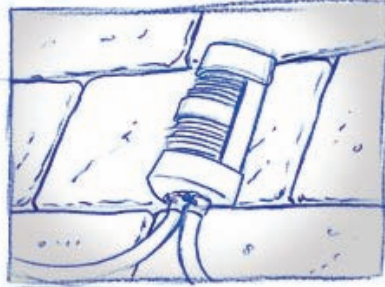
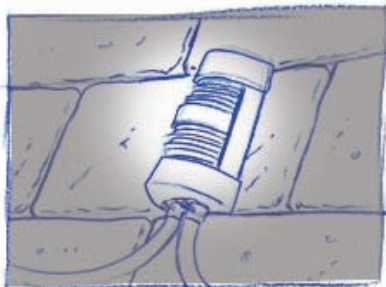
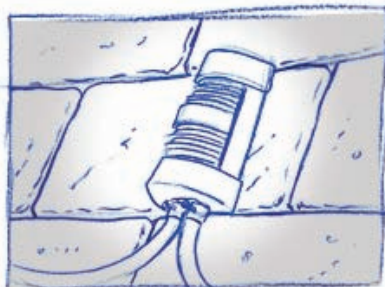
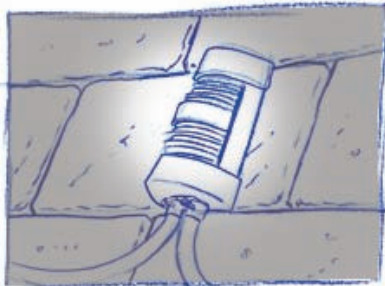
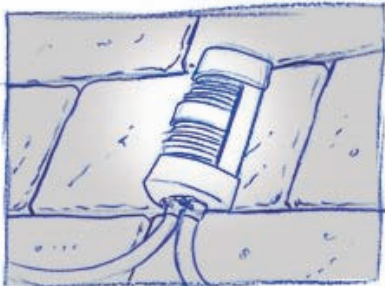
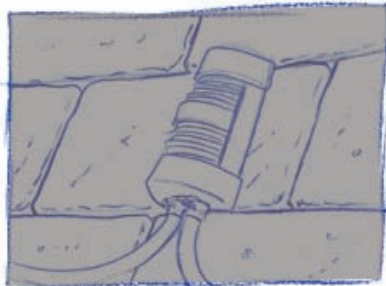

"Got!"

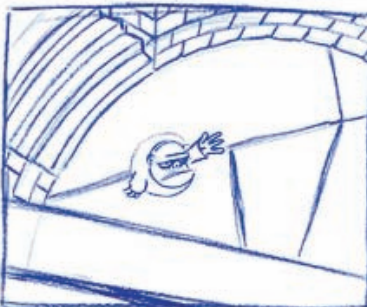
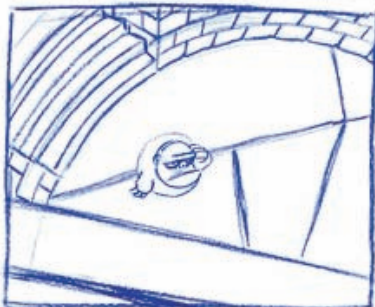
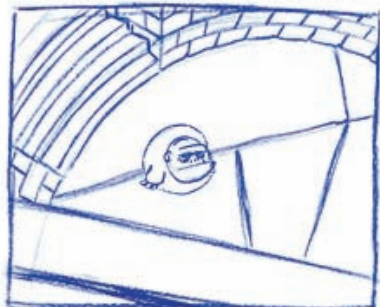

"TURN THE VALVES ON THE MAIN FUEL TANKS."

"YES, MASTER"

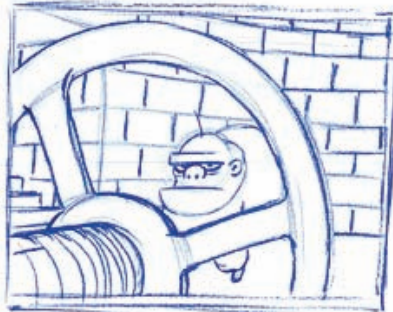
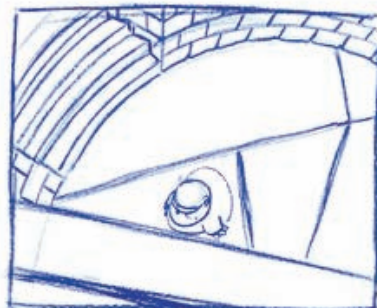



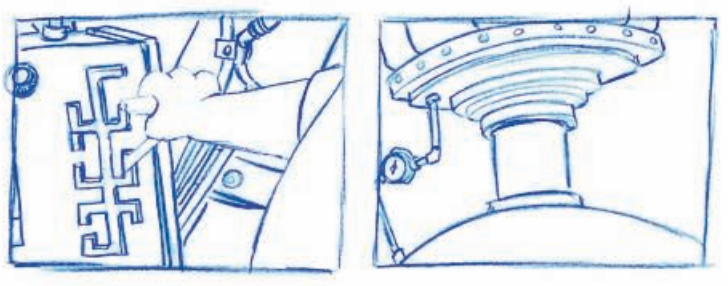
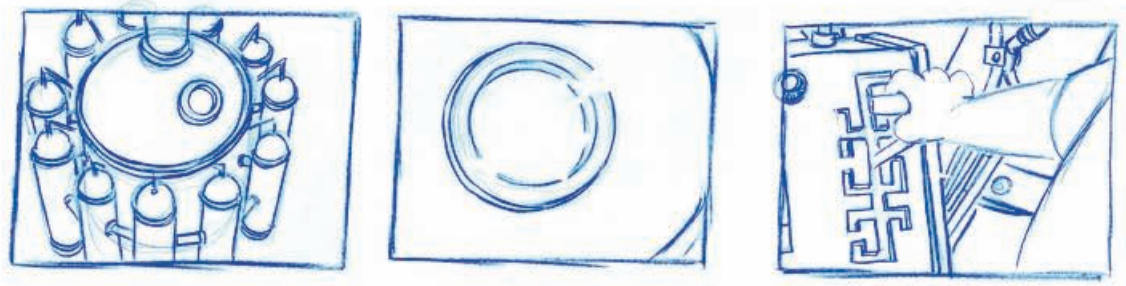
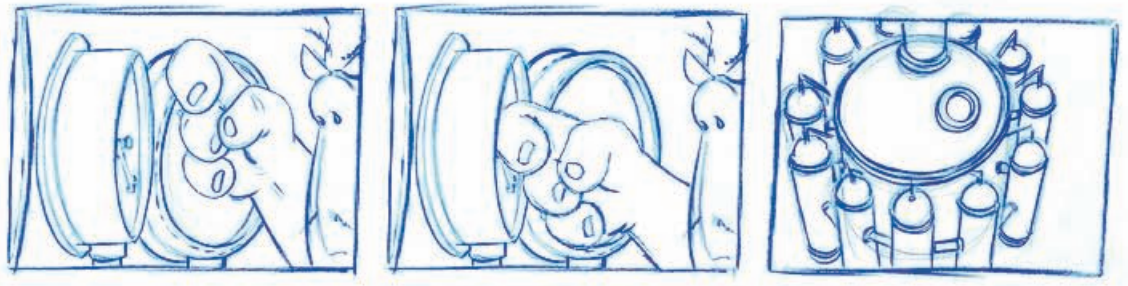
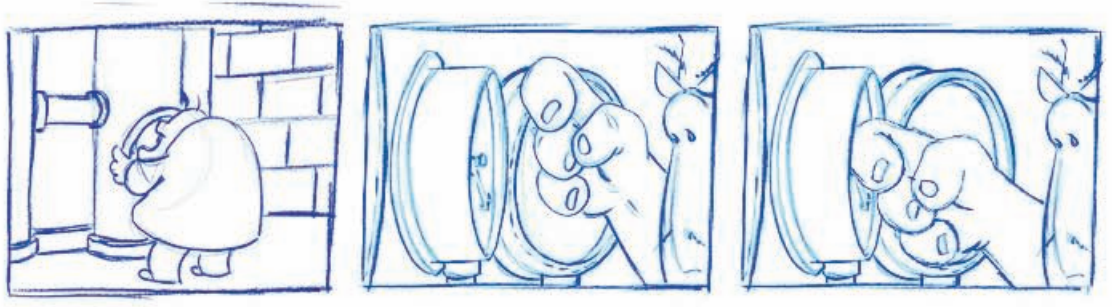



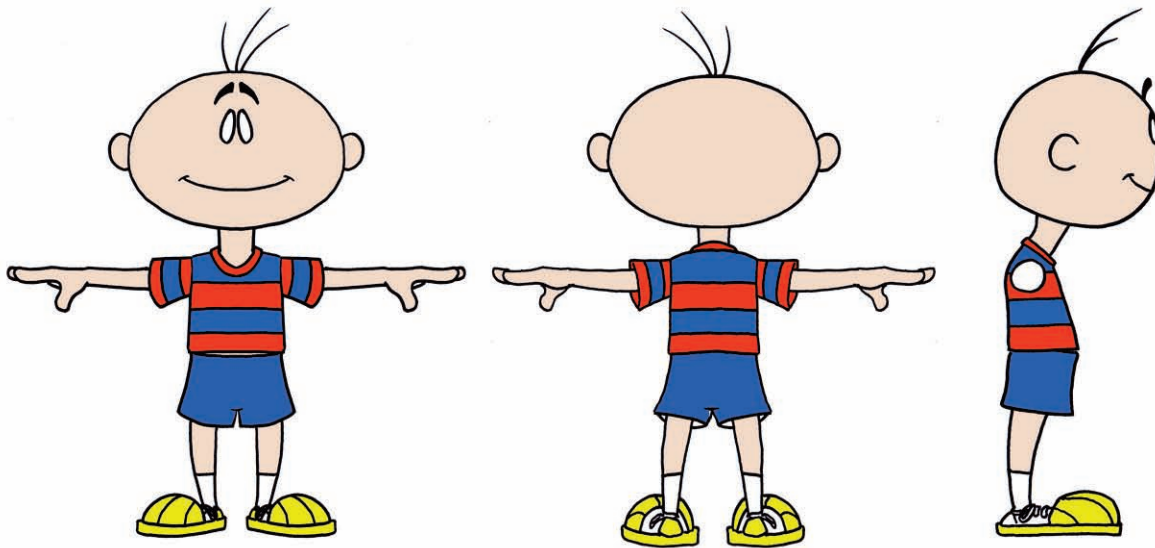

## Max T-poses

Note: Do NOT model eyes, mouth, or eyebrows as 3D objects. These will hand drawn and then be projected onto a plane or the surface of the head.

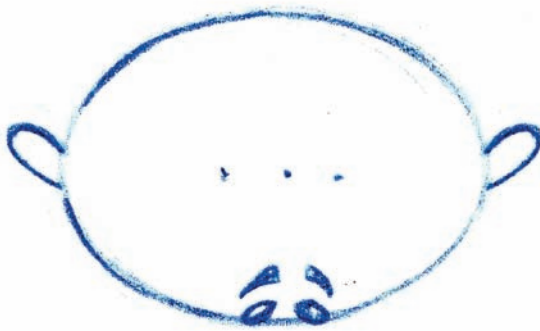

TOP  
VIEW



3 FINGERS

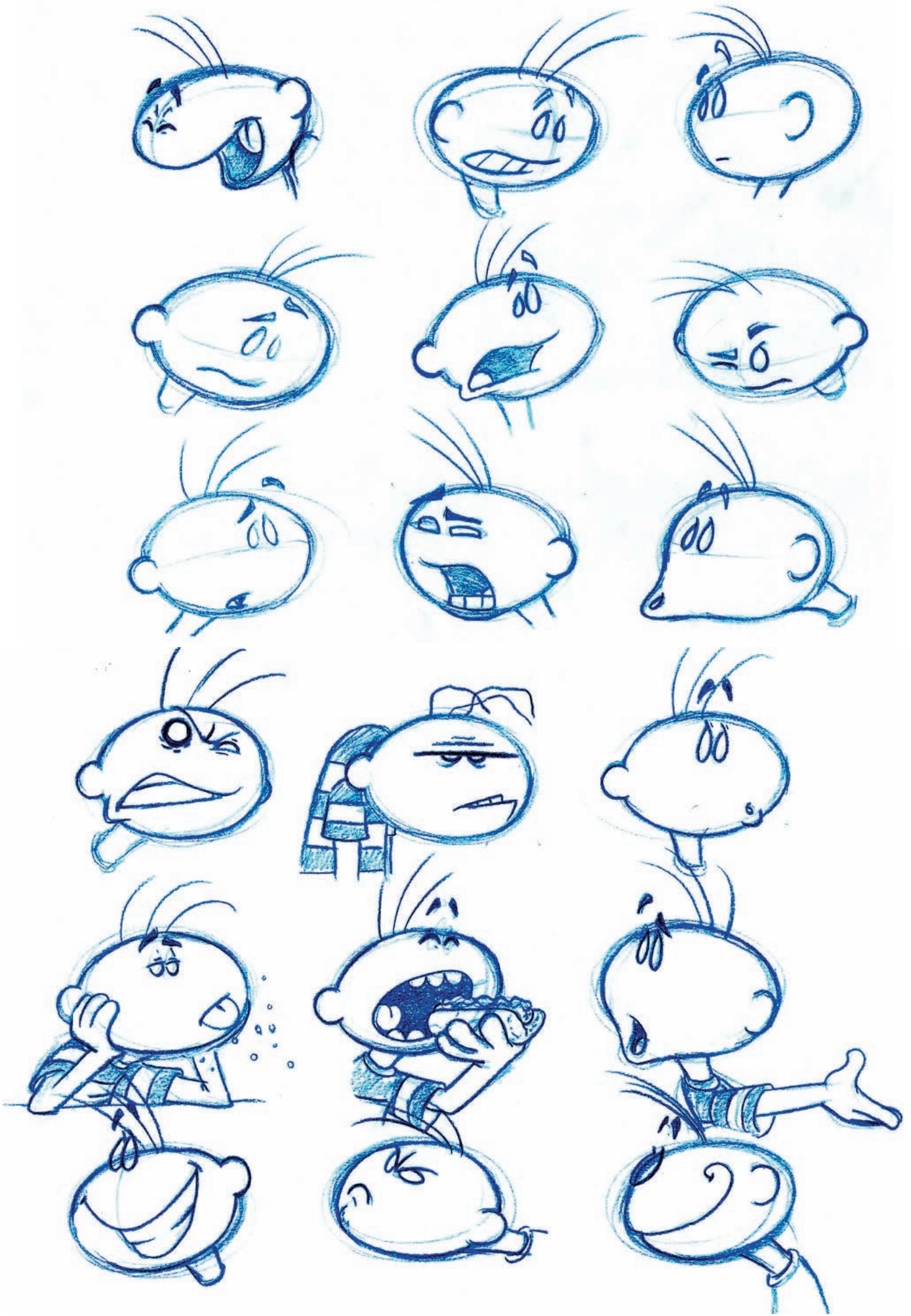



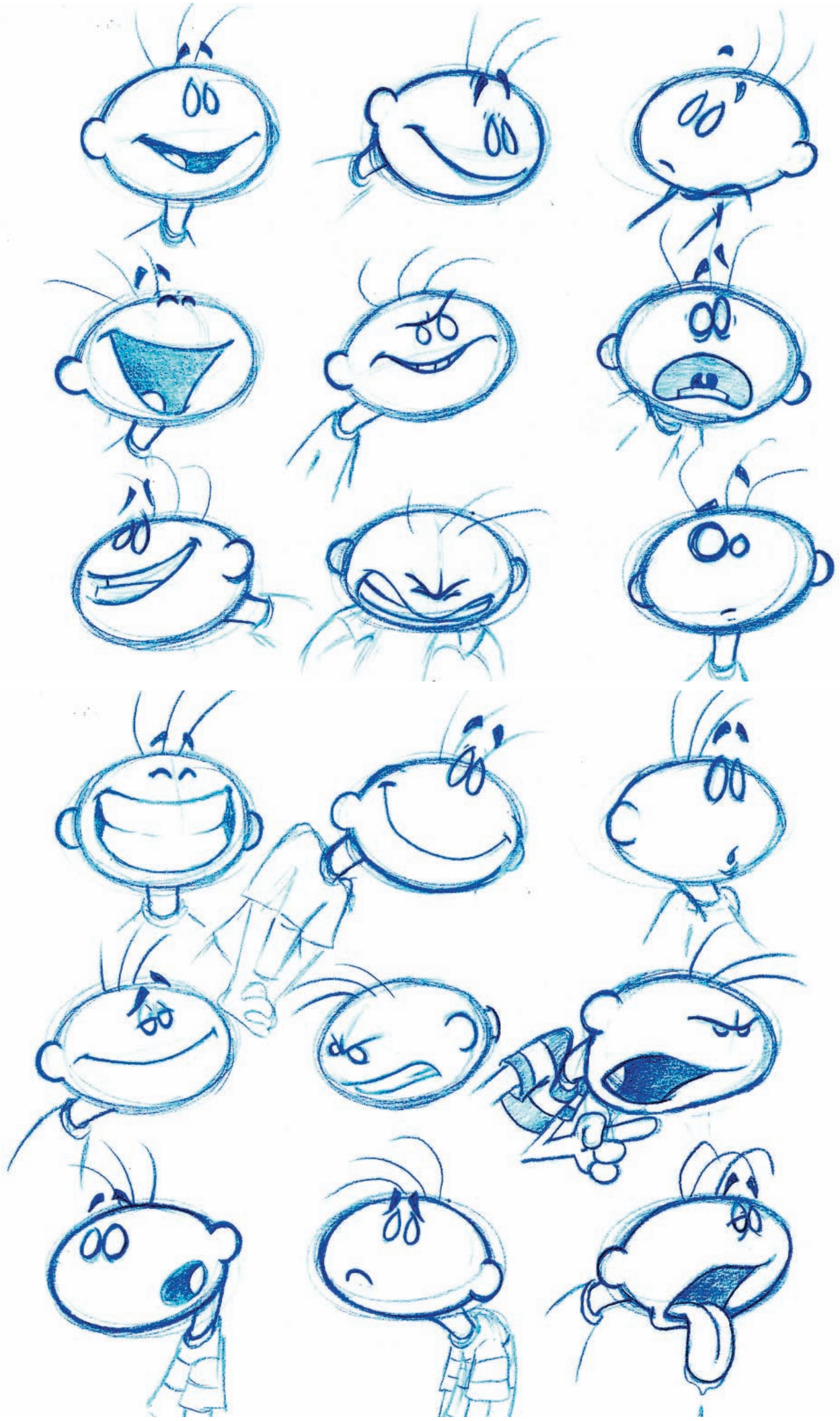





BRAW EMAY

© 2005



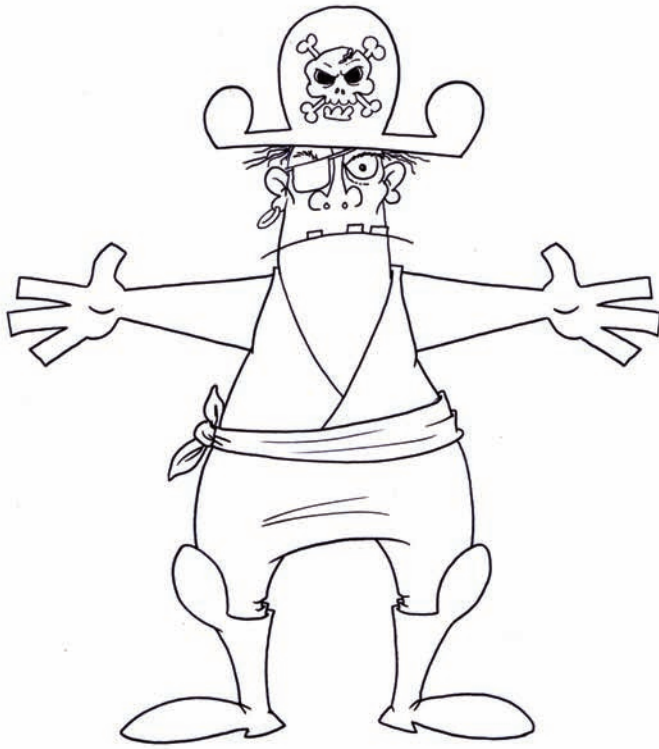

**Pirate Captain**

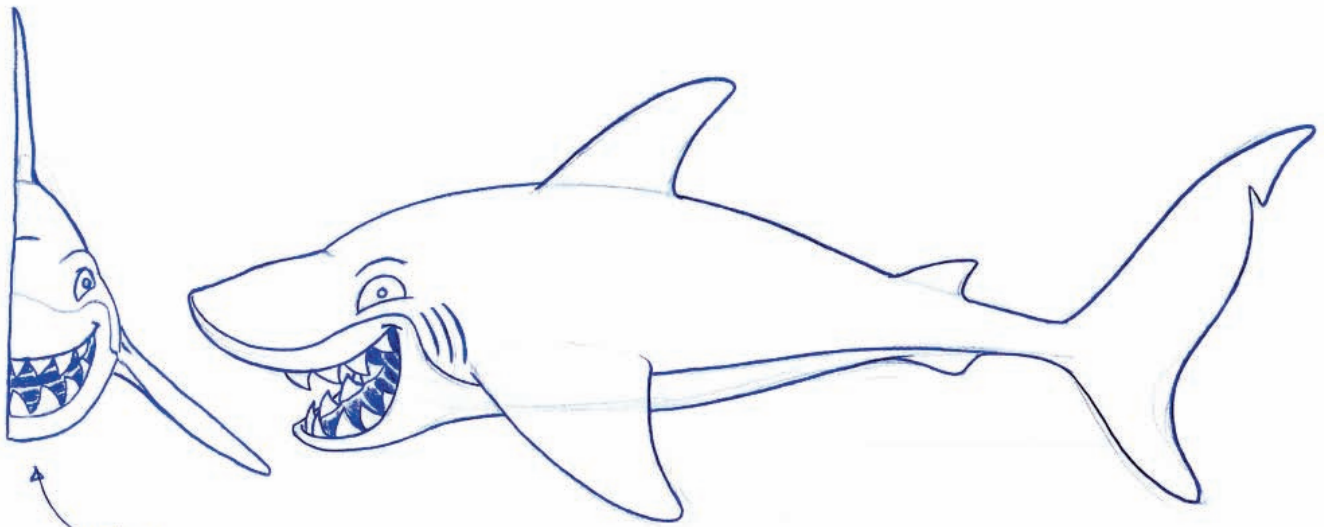

HE'S ACTUALLY FLAT  
ON ONE SIDE

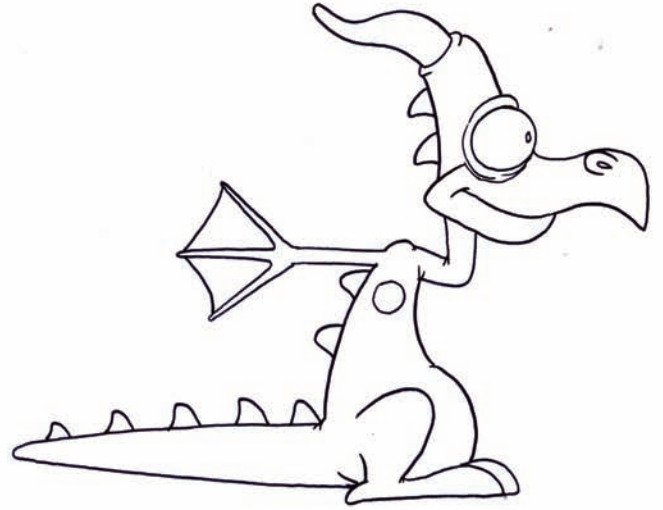
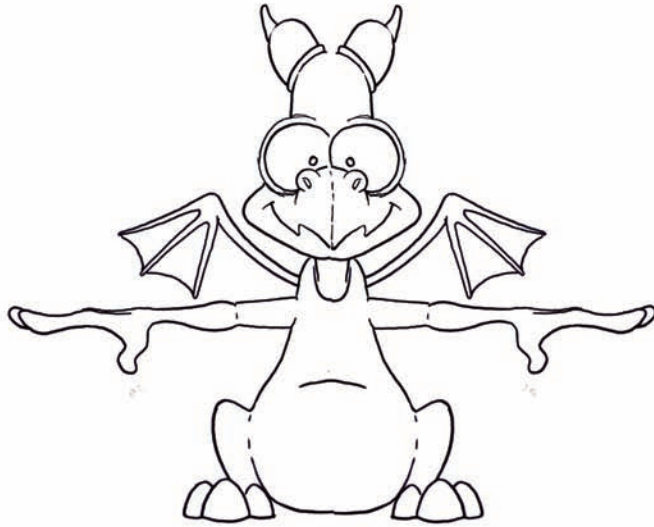

**Baby Dragon**

